

Timber Chain

Welded Steel Chain (Offset Side Bar)

Chain Ref	Pitch		Average Ultimate Strength lbs.	Max. Working Load lbs.	Approx. Links Per Foot	Average Weight lbs./ft.	Dimensions						
	mm	Inches					CE	X	D	T	F	H	A
WR78	66.26	2.609	24000	3000	4.6	4.0	76.20	50.80	12.70	6.35	28.58	22.23	28.58
WH78	66.26	2.609	36000	3500	4.6	4.0	76.20	50.80	12.70	6.35	28.58	22.23	28.58
WR82	66.26	2.609	26000	3800	4.6	4.0	76.20	50.80	12.70	6.35	28.58	22.23	28.58
WH82	66.26	2.609	40000	4500	4.6	4.0	76.20	50.80	12.70	6.35	28.58	22.23	28.58
WR124	101.60	4.000	46000	6300	3.0	8.3	107.95	69.85	19.05	9.53	38.10	31.75	38.10
WH124	101.60	4.000	60000	7350	3.0	8.3	107.95	69.85	19.05	9.53	38.10	31.75	38.10
WR111	120.90	4.760	46000	7550	2.5	9.5	123.83	85.00	19.05	9.53	44.45	31.75	50.80
WH111	120.90	4.760	60000	8850	2.5	9.5	123.83	85.00	19.05	9.53	44.45	31.75	50.80
WR106	152.40	6.000	46000	6750	2.0	7.0	107.95	69.85	19.05	9.53	38.10	31.75	41.28
WH106	152.40	6.000	69000	7200	2.0	7.0	107.95	69.85	19.05	9.53	38.10	31.75	41.28
WR110	152.40	6.000	46000	6750	2.0	7.2	117.48	76.20	19.05	9.53	38.10	31.75	47.63
WH110	152.40	6.000	69000	7900	2.0	7.2	117.48	76.20	19.05	9.53	38.10	31.75	47.63
WR132	153.67	6.050	84000	13100	2.0	14.2	158.75	111.00	25.40	12.70	50.80	41.28	73.03
WH132	153.67	6.050	110000	15000	2.0	14.2	158.75	111.00	25.40	12.70	50.80	41.28	73.03
WR150	153.67	6.050	84000	13100	2.0	16.8	158.75	111.00	25.40	12.70	63.50	41.28	73.03
WH150	153.67	6.050	110000	15300	2.0	16.8	158.75	111.00	25.40	12.70	63.50	41.28	73.03

WR - Welded steel chain c/w heat treated rivets

WH - Welded steel chain - fully heated treated

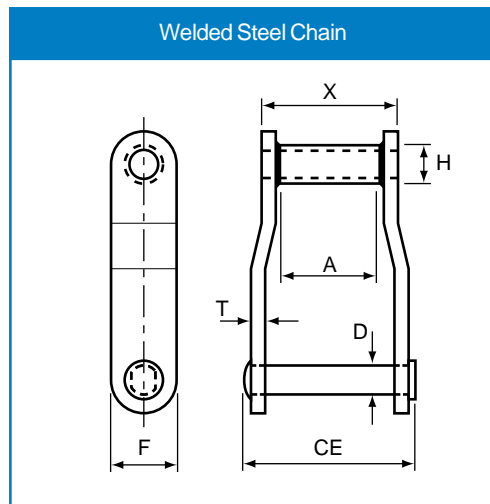

Timber Chain

Welded Steel Chain Attachments (Offset Side Bar)

Attachment Ref	Chain Ref.	Weight Per Ft lbs	Dimensions												
			A	D	E	F	G	H	K	M	R	T	X	Y	Z
A1	WR/WH78	4.97	50.80	9.58	31.75	12.70	20.57	31.75	-	-	14.27	6.35	-	-	-
A1	WR/WH82	6.50	54.10	9.58	44.45	15.88	23.88	38.10	-	-	15.88	6.35	-	-	-
A1	WR/WH124	8.40	66.68	15.88	50.80	15.88	28.70	45.97	-	-	19.05	9.53	-	-	-
A2	WR/WH78	4.50	50.80	9.58	54.10	12.70	19.81	10.41	-	28.70	14.27	6.35	-	-	-
A2	WR/WH82	6.00	54.10	9.53	57.15	15.80	23.88	12.70	-	31.75	15.88	7.92	-	-	-
A2	WR/WH124	10.00	66.68	9.58	76.20	22.23	28.70	22.23	-	49.28	19.05	9.53	-	-	-
A2	WR/WH132	17.00	95.25	12.70	101.60	19.05	38.10	41.28	-	69.85	25.40	12.70	-	-	-
A225	WR/WH124	8.90	101.60	-	50.80	49.28	-	50.80	-	-	19.05	12.70	-	57.15	22.23
F10	WR/WH82	4.80	-	-	31.75	-	-	23.80	-	-	15.88	6.35	260.35	-	-
F30	WR/WH78	9.90	-	-	25.40	-	-	68.33	-	-	14.27	54.10	76.20	-	-
F659	WR/WH124	13.10	-	-	44.45	-	-	120.65	-	-	19.05	-	167.39	-	-

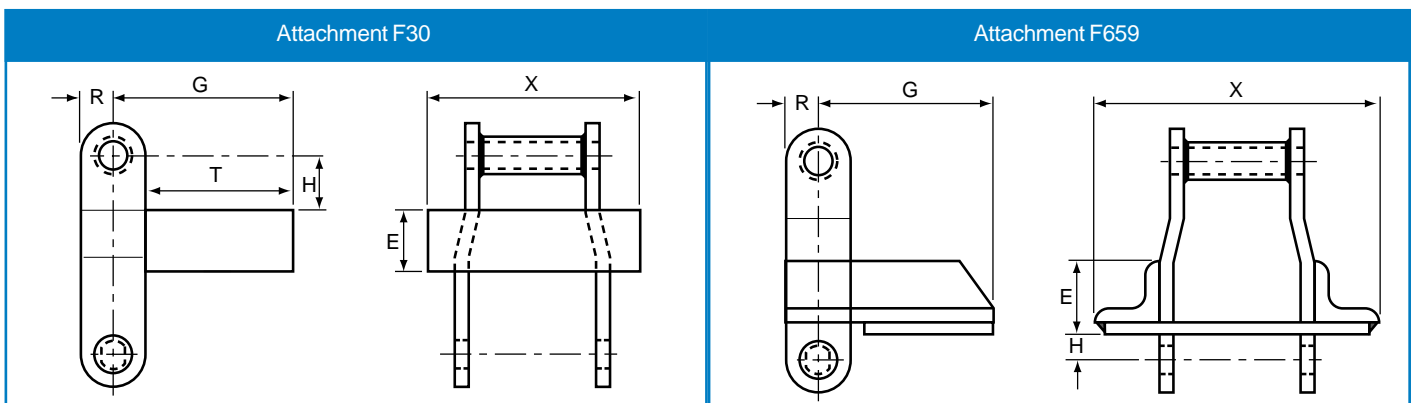
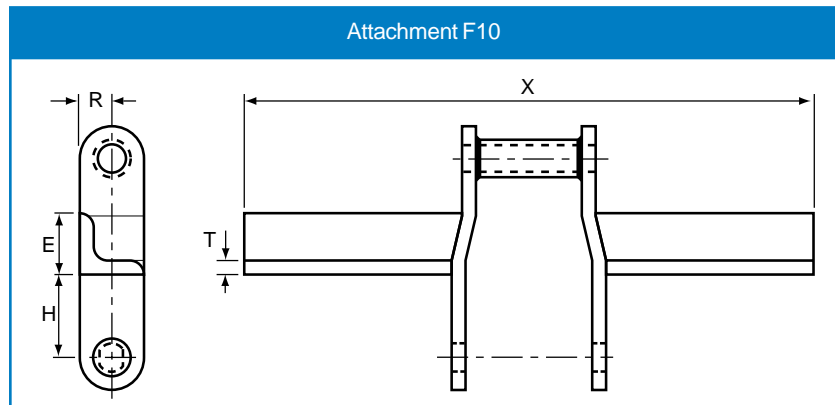
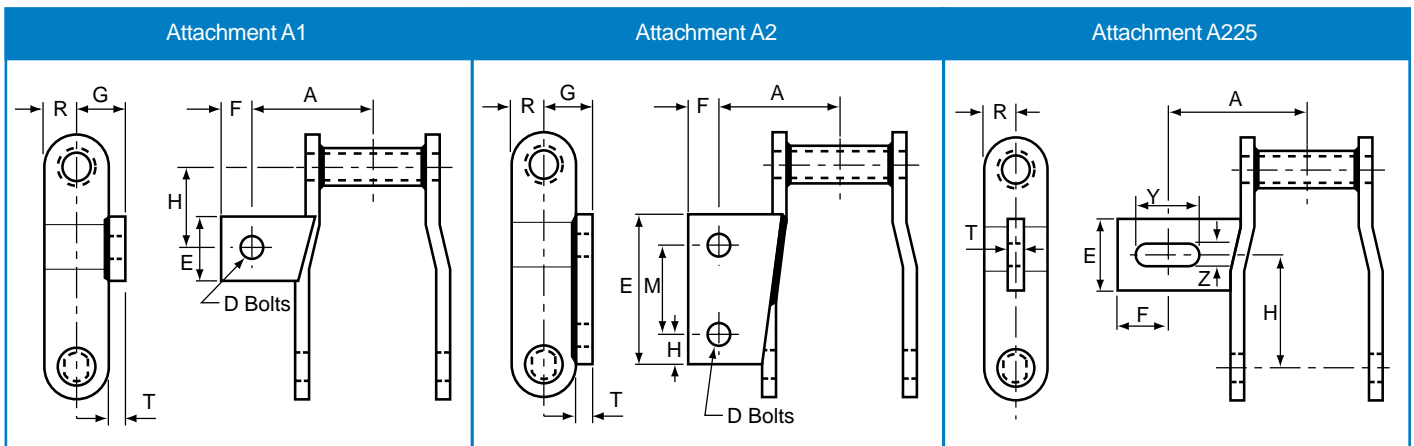

Every effort has been taken to ensure that the data listed in this catalogue is correct. Challenge accepts no liability for any inaccuracies or damage caused. All dimensions in millimetres unless otherwise stated.

Timber Chain

Welded Steel Chain Attachments (Offset Side Bar)

Attachment Ref	Chain Ref.	Weight Per Ft lbs	Dimensions												
			A	D	E	F	G	H	K	M	R	T	X	Y	Z
H2	WR/WH78	4.75	-	-	-	-	90.42	7.87	25.40	-	14.22	6.35	-	-	-
H2	WR/WH82	9.00	-	-	-	-	91.95	15.75	28.70	-	15.75	4.83	-	-	-
K1	WR/WH78	4.97	50.80	9.65	31.75	12.70	20.57	31.75	-	-	14.22	6.35	-	-	-
K1	WR/WH82	6.50	54.10	9.65	44.45	15.75	23.88	38.10	-	-	15.75	6.35	-	-	-
K1	WR/WH124	11.70	66.55	15.75	50.80	15.75	28.70	45.97	-	-	19.05	9.65	-	-	-
K2	WR/WH78	5.00	50.80	9.65	54.10	12.70	19.81	10.41	-	28.70	14.22	6.35	-	-	-
K2	WR/WH82	8.00	54.10	9.65	57.15	15.75	23.88	12.70	-	31.75	15.75	7.87	-	-	-
K2	WR/WH124	12.00	66.55	9.65	76.20	22.35	28.70	22.35	-	49.28	19.05	9.65	-	-	-
K2	WR/WH132	19.00	95.25	12.70	101.60	19.05	38.10	41.15	-	69.85	25.40	12.70	-	-	-
RR	WR/WH78	4.70	-	-	-	-	38.10	19.05	-	-	14.22	6.35	-	-	-
RR	WR/WH82	7.00	-	-	-	-	44.45	20.57	-	-	15.75	6.35	-	-	-
RR	WR/WH124	10.00	-	-	-	-	47.75	38.10	-	-	19.05	9.65	-	-	-

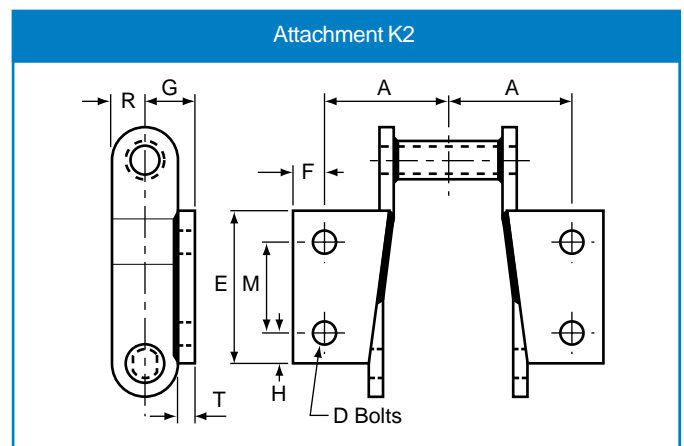
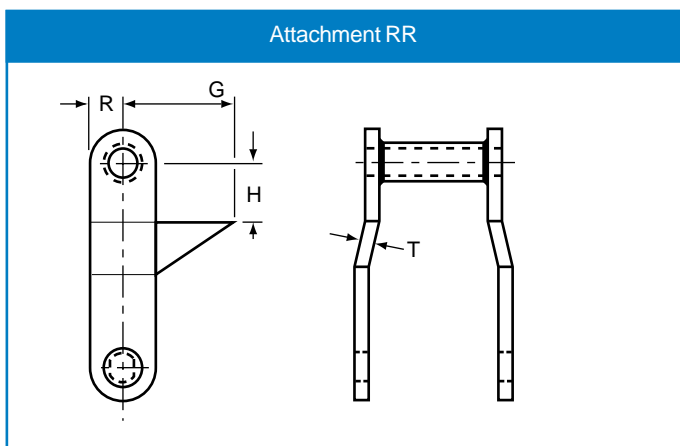
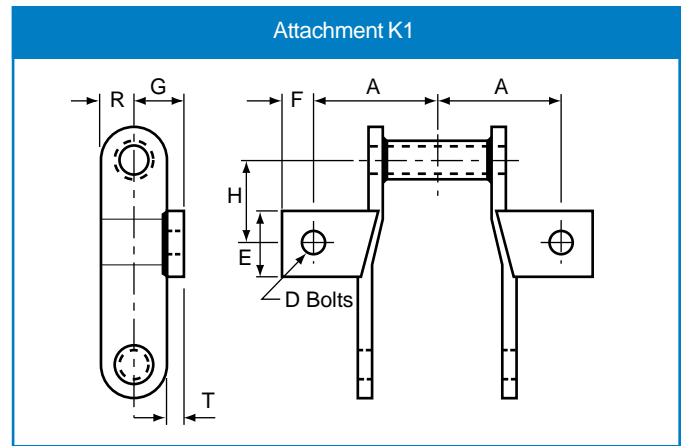
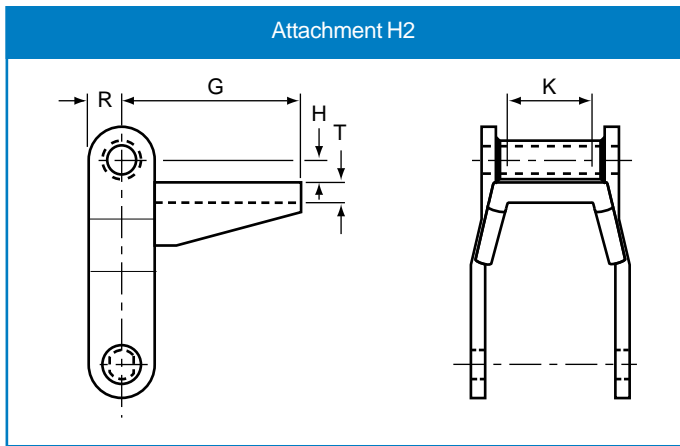

Timber Chain

Offset Sidebar Roller Chain

Offset Sidebar Roller Chain

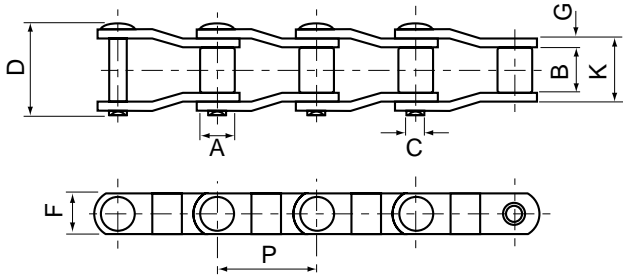

Material Spec.

	Sidebar	Pin	Bushing	Roller
S0-578	CH	CH	CC	CC
M0-88	C	CH	CC	CC
LXS-882	CH	AH	AC	CH
M0H-578	CH	CH	CC	CH

Chain No.	Pitch		Average Ultimate Strength lbs.	Max. Working Load lbs.	Approx. Links Per Foot	Average Weight lbs./ft.	Dimensions						
	inch	mm					A	B	C	D	F	G	K
S0-578	2.609	66.269	19,000	2,200	4.6	2.7	22.23	26.99	9.53	52.78	25.40	3.97	36.51
M0-88	2.609	66.269	20,000	2,400	4.6	3.8	22.23	26.99	11.11	59.53	28.58	6.35	41.28
LXS-882	2.609	66.269	29,000	2,800	4.6	3.9	22.23	28.58	11.11	59.53	28.58	6.35	42.86
M0H-578	2.609	66.269	19,000	2,200	4.6	2.7	22.23	26.99	9.53	52.78	25.40	5.56	36.12

Straight Sidebar Roller Chain

Straight Sidebar Roller Chain

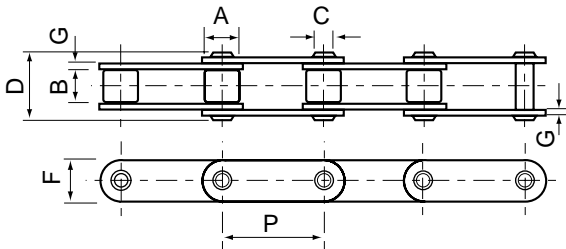

Material Spec.

	Sidebar	Pin	Bushing	Roller
MS-88	C	CH	CC	CC
81-X	CH	AC	AC	CH
81-XH	CH	AC	AC	CH
81-XHS	CH	AC	AC	CH
SS-188	CH	AC	CC	CC

Chain No.	Pitch		Average Ultimate Strength lbs.	Max. Working Load lbs.	Approx. Links Per Foot	Average Weight lbs./ft.	Dimensions							
	inch	mm					A	B	C	D	F	K	Side Plate Thickness (G) Chain Conn	
MS-88	2.609	66.269	26,000	2,500	4.6	3.8	22.23	26.99	11.11	59.53	28.58	41.28	6.35	6.35
81-X	2.609	66.269	22,000	2,200	4.6	2.6	23.02	26.99	11.11	47.23	28.58	34.93	3.97	3.97
81-XH	2.609	66.269	41,800	5,000	4.6	3.9	23.02	26.99	11.11	59.18	31.75	42.86	7.94	5.56
81-XHS	2.609	66.269	41,800	5,000	4.6	4.2	23.02	26.99	11.11	63.50	32.94	42.86	7.94	7.94
SS-188	2.609	66.269	26,000	2,500	4.6	3.8	22.23	26.99	11.11	59.53	28.58	41.28	6.35	6.35

Material Designation

- C: Carbon Steel
- CC: Carbon Steel Case Hardened
- AC: Alloy Steel Case Hardened
- CH: Carbon Steel Heat Treated
- AH: Alloy Steel Heat Treated

Timber Chain

Welded Steel Drag Chain

Chain Ref	Pitch		Average Ultimate Strength lbs.	Max. Working Load lbs.	Approx. Links Per Foot	Average Weight lbs.	Dimensions					
	mm	Inches					CE	X	A	E	D	F
WD104	152.4	6	51000	8500	20	8.7	174.75	136.65	19.05	9.65	104.65	38.1
WD110	152.4	6	51000	8500	20	12.0	301.75	263.65	19.05	9.65	228.60	38.1
WD120	152.4	6	80000	12300	20	19.4	304.80	257.05	22.35	12.70	215.90	50.8
WD122	203.2	8	80000	12300	15	16.0	304.80	257.05	22.35	12.70	215.90	50.8
WD480	203.2	8	80000	12300	15	18.1	371.35	323.75	22.35	12.70	279.40	50.8

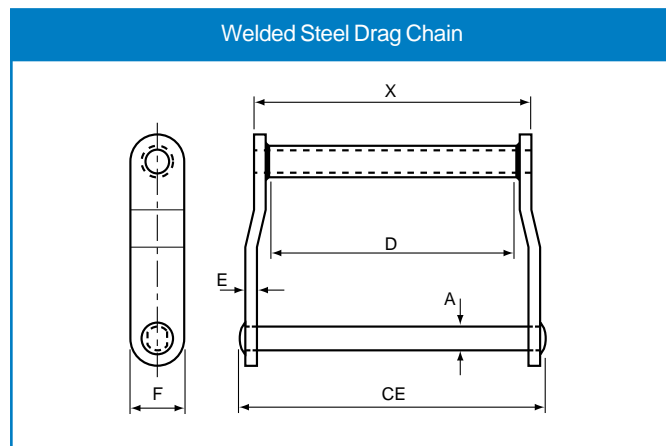

Drag Chain Attachments

Attachment Ref	Chain Ref	Dimensions			
		S	B	G	T
C1	WD104	104.65	9.53	57.15	9.53
W1	WD104	304.80	47.63	-	9.53
W1	WD120	431.80	44.45	-	12.70

