

HRC Couplings

HRC Common Data

Coupling No	Nominal Torque Nm	Overall Diameter A	Hub Diameter B	Assembled Length F	Element		Parallel Misalignment (mm)	Weight (kg)	Assembled Length (L)		
					Ring Dia E	Ring Width G			FF, FH, HH	FB, HB	BB
70	31	69	60	25.5	31	18.5	0.3	1.00	65.5	65.5	65.5
90	80	85	70	30.5	32	22.5	0.3	1.17	69.5	76.5	82.5
110	160	112	100	45.5	45	29.5	0.3	5.00	82.5	100.5	119.5
130	315	130	105	53.5	50	36.5	0.4	5.46	89.5	110.5	131.5
150	600	150	115	60.5	62	40.5	0.4	7.11	107.5	129.5	152.5
180	950	180	125	73.5	77	49.5	0.4	16.65	142.5	165.5	189.5
230	2000	225	155	85.5	99	59.5	0.5	26.05	164.5	202.5	239.5
280	3150	275	206	105.5	119	74.5	0.5	50.05	207.5	246.5	285.5

Angular misalignmet capacity up to 1 deg

Mass is for an FF, FH or HH coupling with mid range Taper Lock Bushes
 F refers to combinations of flanges: FF, FH, HH, FB, HB, BB.

HRC Type F & H

Coupling No	Bush size	Max. Bore		Shoulder Width D	Hub Width C
		(mm)	(ins)		
70	1008	25	1	20.0	23.5
90	1108	28	1.1/8	19.5	23.5
110	1610	42	1.5/8	18.5	26.5
130	1610	42	1.5/8	18.0	26.5
150	2012	50	2	23.5	33.5
180	2517	60	2.1/2	34.5	46.5
230	3020	75	3	39.5	52.5
280	3525	100	4	51.0	66.5

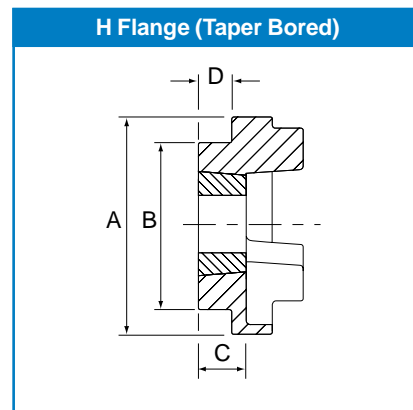
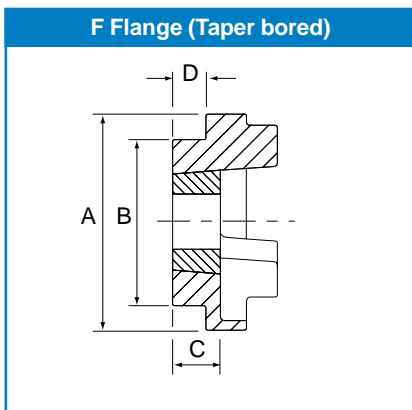
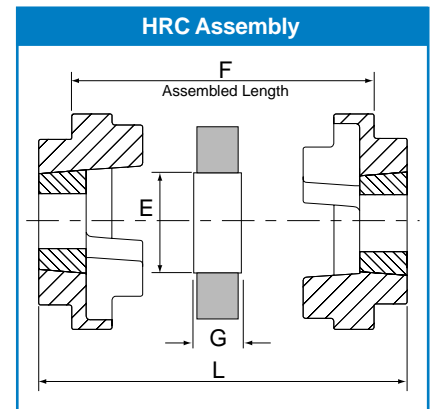

HRC Type B

Coupling No	Max. Bore (mm)	Pilot Bore (mm)	Keyway Screw Size	Shoulder Width D	Hub Width C
70	32	8	M6	20	23.5
90	42	10	M6	26	30.5
110	55	10	M10	37	45.5
130	60	15	M10	39	47.5
150	70	20	M10	46	56.5
180	80	25	M10	58	70.5
230	100	25	M12	77	90.5
280	115	30	M16	90	105.5

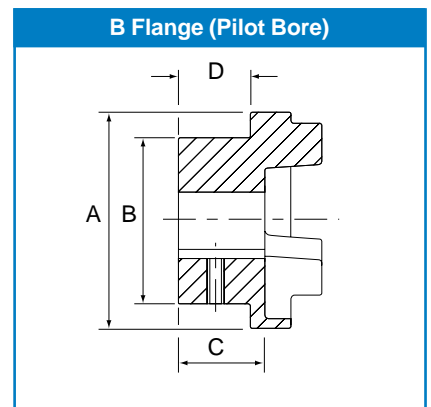

All dimensions in millimetres unless otherwise stated. Every effort has been taken to ensure that the data listed in this catalogue is correct. Challenge accepts no liability for any inaccuracies or damage caused